



ACACIA BALLROOM

EXPAND YOUR THINKING ... MEETINGS AND EVENTS FOR 300 GUESTS

For larger-scale Las Vegas gatherings, Four Seasons is your premier choice – providing up to 300 rooms per night, and hosting meetings and events for up to 300 guests. With contemporary style and a non-gaming atmosphere, Four Seasons elevates your occasion with a AAA Five-Diamond experience.

LOCATION

- Conveniently positioned at the south end of the Las Vegas Strip, within the Mandalay Bay Resort complex
- Private arrival experience with exclusive Four Seasons driveway and porte cochere
- 15 minutes (3 miles/4.8 kilometers) from McCarran International Airport (LAS)

EVENT VENUES

- Total of 38,200 sq. ft. (3,548 m²) of flexible space
- 10,080 sq. ft. (936 m²) Four Seasons Ballroom with 3,920 sq. ft. (364 m²) of pre-function space
- 5,250 sq. ft. (488 m²) Acacia Ballroom with 1,950 sq. ft. (181 m²) of pre-function space
- Six meeting rooms, ranging from 203 to 1,702 sq. ft. (19 to 158 m²)

SIGNATURE SETTINGS

- Fountain Terrace for private outdoor events for up to 400 guests
- Two stylish Hospitality Suites, located on floors 38 and 39 – each hosting up to 75 people for receptions
- PRESS Patio, a chic outdoor lounge with comfortable seating and two fire pits, overlooking the pool and gardens – accommodating up to 80 people for receptions

Four Seasons Hotel Las Vegas
3960 Las Vegas Boulevard South
Las Vegas, Nevada 89119 U.S.A.
Tel. 702 632-5297

CONNECT WITH US

fourseasons.com/lasvegas



LOBBY LEVEL

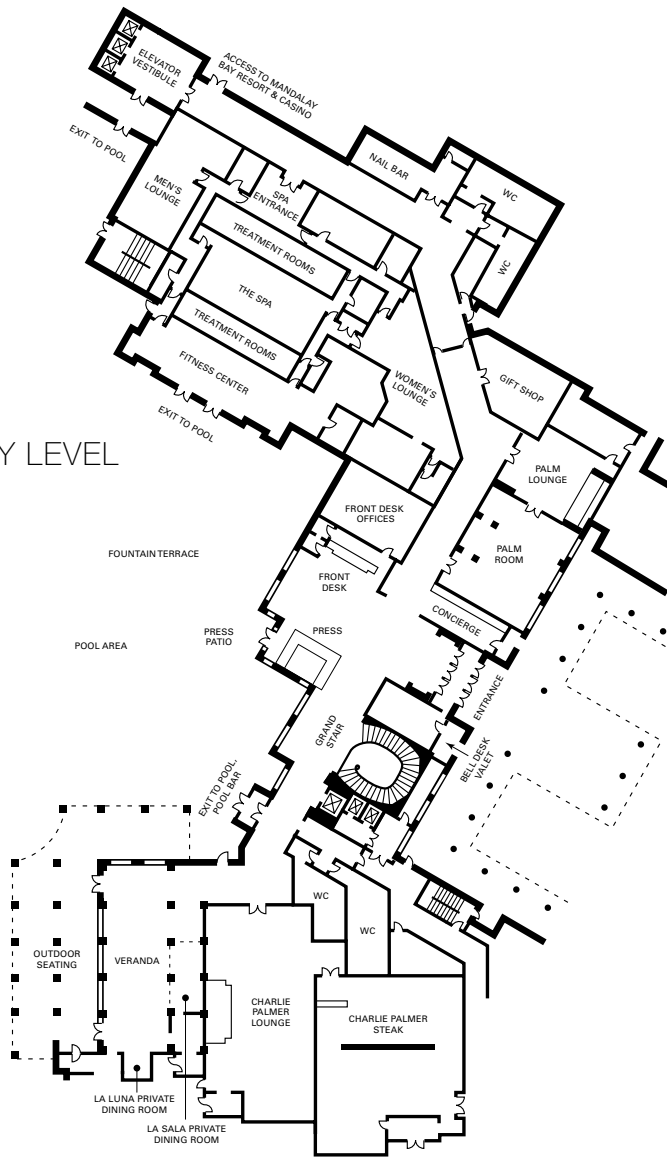

SECOND FLOOR

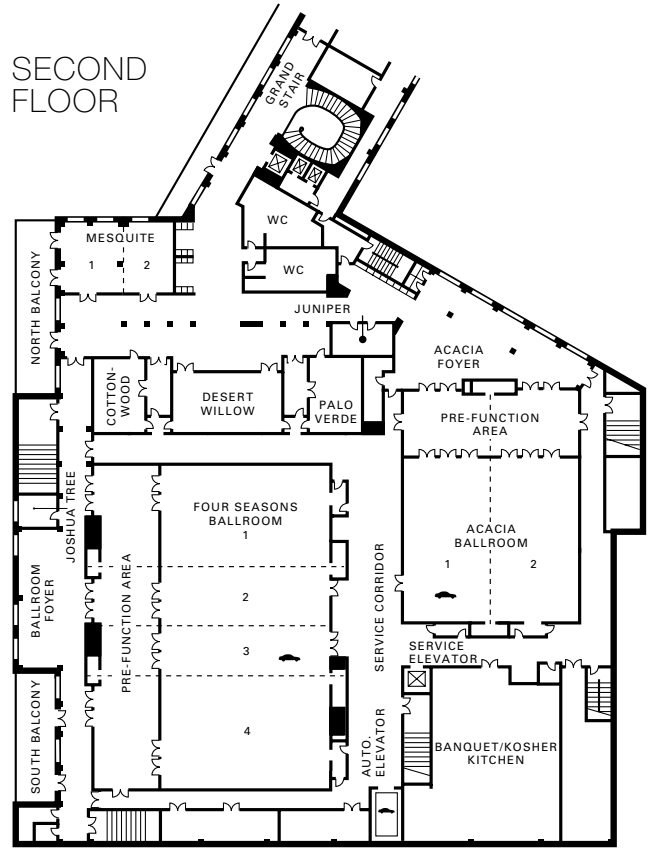

AUTOMOBILE ACCESSIBLE

CAPACITIES

ROOM	Size (sq. ft.)	Size (m ²)	Rounds (10 pp/table)	Boardroom	Classroom	Theatre	U-shape	Hollow Square	Reception
Lobby Level									
Palm Room*	1,702	158	120	36	60	120	32	40	200
Pool*	-	-	300	-	-	-	-	-	500
Fountain Terrace*	5,950	552	300	-	-	400	-	-	400
Second Floor									
Four Seasons Ballroom	10,080	936	600	-	600	750	-	-	900
Four Seasons Pre-Function	3,920	364	200	-	-	300	-	-	240
Acacia Ballroom	5,250	487	300	-	300	380	-	-	450
Acacia Ballroom Pre-Function	1,950	181	120	-	80	136	-	-	140
Mesquite Room*	1,590	148	120	-	70	100	-	-	140
Mesquite One*	960	89	80	22	48	60	27	36	80
Mesquite Two*	630	59	40	22	24	40	24	30	60
Desert Willow	1,196	111	80	36	60	100	36	42	100
North Balcony*	852	79	-	-	-	-	-	-	60
Cottonwood	672	62	50	22	24	56	24	30	50
Palo Verde	672	62	50	22	24	56	24	30	50
Joshua Tree*	203	19	-	-	-	-	-	-	-
Juniper	228	21.2	10	8	-	-	-	-	-
Mojave Boardroom* (38th Floor)	2,100	195	-	14	-	-	-	-	75
Sierra Boardroom* (39th Floor)	2,100	195	-	14	-	-	-	-	75

*Indicates function rooms with natural light or outdoor space.