

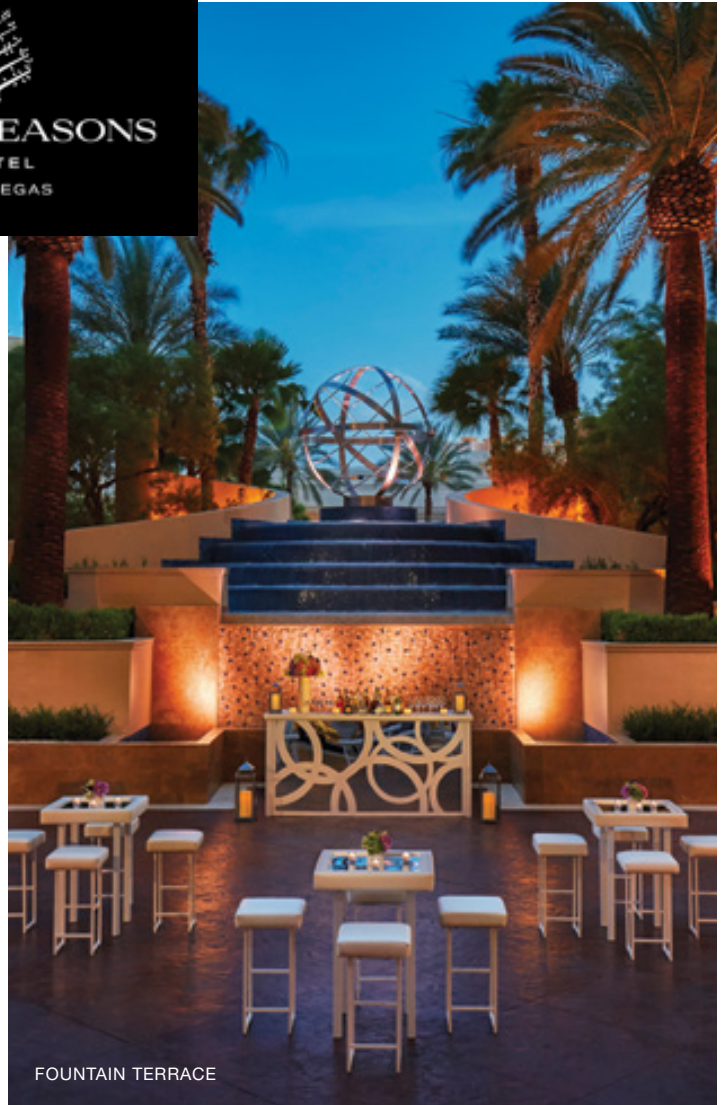

PRESS PATIO



FOUNTAIN TERRACE



VERANDA

**UNIQUE SPACES FOR ALL OCCASIONS**  
Impress your group – whether friends, family or business colleagues – with an unforgettable dining experience at Four Seasons Hotel Las Vegas. Diverse, flexible indoor-outdoor venues ensure a perfect setting for a variety of gatherings, and our intuitive, personalized service creates a seamless event from start to finish.

### LOCATION

- Conveniently located at the south end of the Las Vegas Strip, within the Mandalay Bay Resort complex
- Exclusive Four Seasons driveway with porte cochère and valet service, just steps from our dining venues – a rare advantage on the Las Vegas Strip

### VERANDA

- Buyout option; perfect for groups of up to 300 people for receptions and 200 for dinner
- Flexible space, including spacious and lush poolside patio
- Two private dining rooms for 10 to 24 people

### PRESS PATIO

- A chic outdoor lounge overlooking the pool and gardens
- Comfortable sofas and chairs, set beneath twinkling trellis lighting and featuring two firepits
- Hosting up to 150 for receptions or 30 to 80 for dining

### FOUNTAIN TERRACE

- Featuring a picturesque waterfall, seasonal flowers and greenery
- Outdoor setting ideal for imaginative evening events
- Hosting 300 for receptions or 200 for dining

TO BOOK YOUR NEXT EVENT, PLEASE CONTACT THE CATERING DEPARTMENT AT

**Tel. (702) 632-5210**  
**Email. [vgs.catering@fourseasons.com](mailto:vgs.catering@fourseasons.com)**

CONNECT WITH US  
**[fourseasons.com/lasvegas](http://fourseasons.com/lasvegas)**



# LOBBY LEVEL

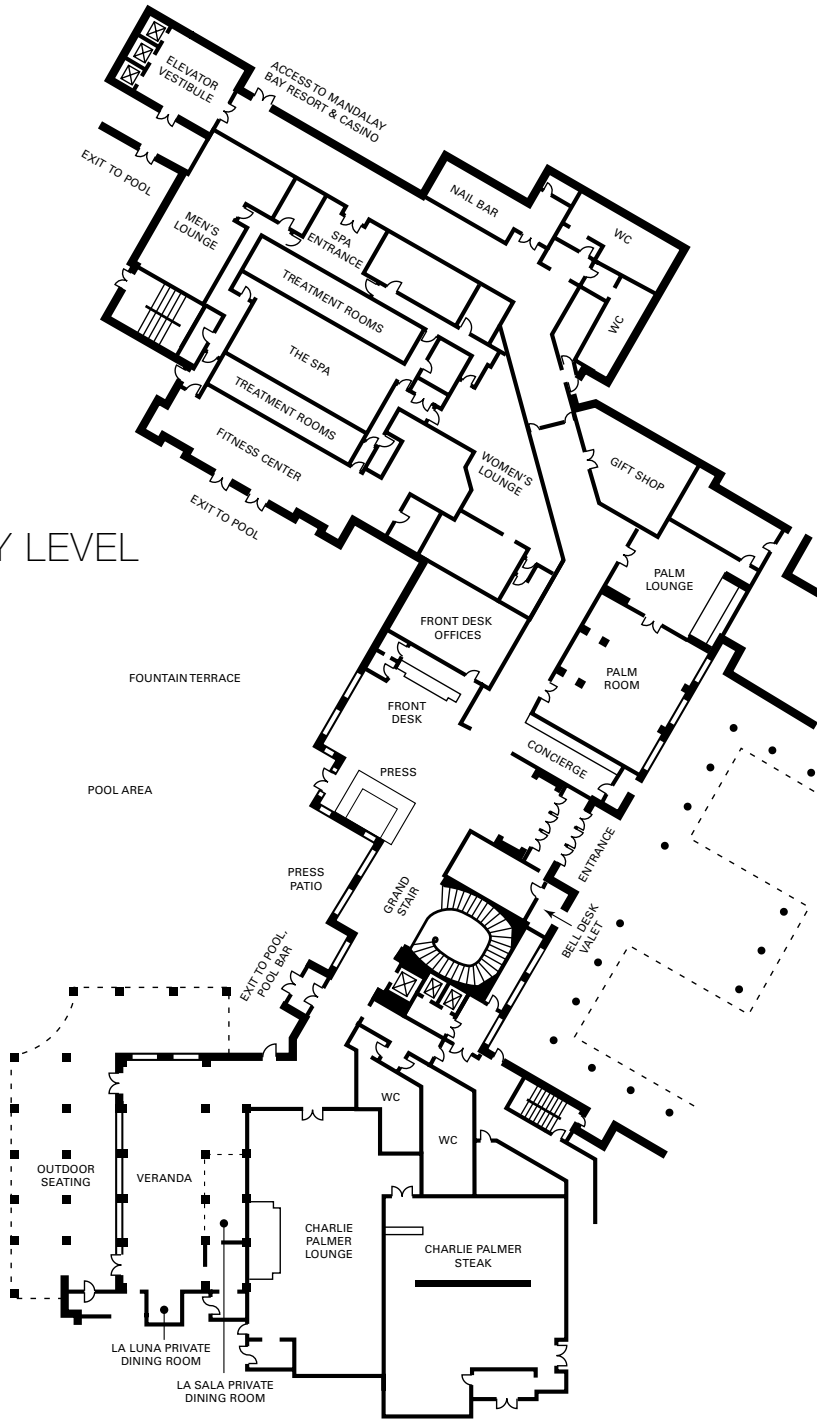

## CAPACITIES

ROOM	Size (sq. ft.)	Size (m <sup>2</sup> )	Rounds (10 pp/table)	Boardroom	Classroom	Theatre	U-shape	Hollow Square	Reception
<b>Lobby Level</b>									
Palm Room*	1,702	158	120	35	60	120	42	48	200
Pool*	-	-	300	-	-	-	-	-	500
Upper Pool Deck*	2,100	191	64	-	-	-	-	-	200
Fountain Terrace*	5,950	552	200	-	-	-	-	-	300
Veranda (Indoors)*	3,745	348	100**	-	-	-	-	-	150
Veranda Patio*	2,863	266	100	-	-	-	-	-	150
Veranda & Patio*	6,608	614	200	-	-	-	-	-	300
La Luna	-	-	10**	-	-	-	-	-	-
La Sala	-	-	24**	-	-	-	-	-	-
Press Patio*	-	-	80	-	-	-	-	-	150

\* Indicates function rooms have natural light or outdoor space.

\*\* Indicates function room will offer its existing set-up and not rounds of 10.